

# Improve your liquid purity with a Self-Cleaning Russell Eco Filter<sup>®</sup>

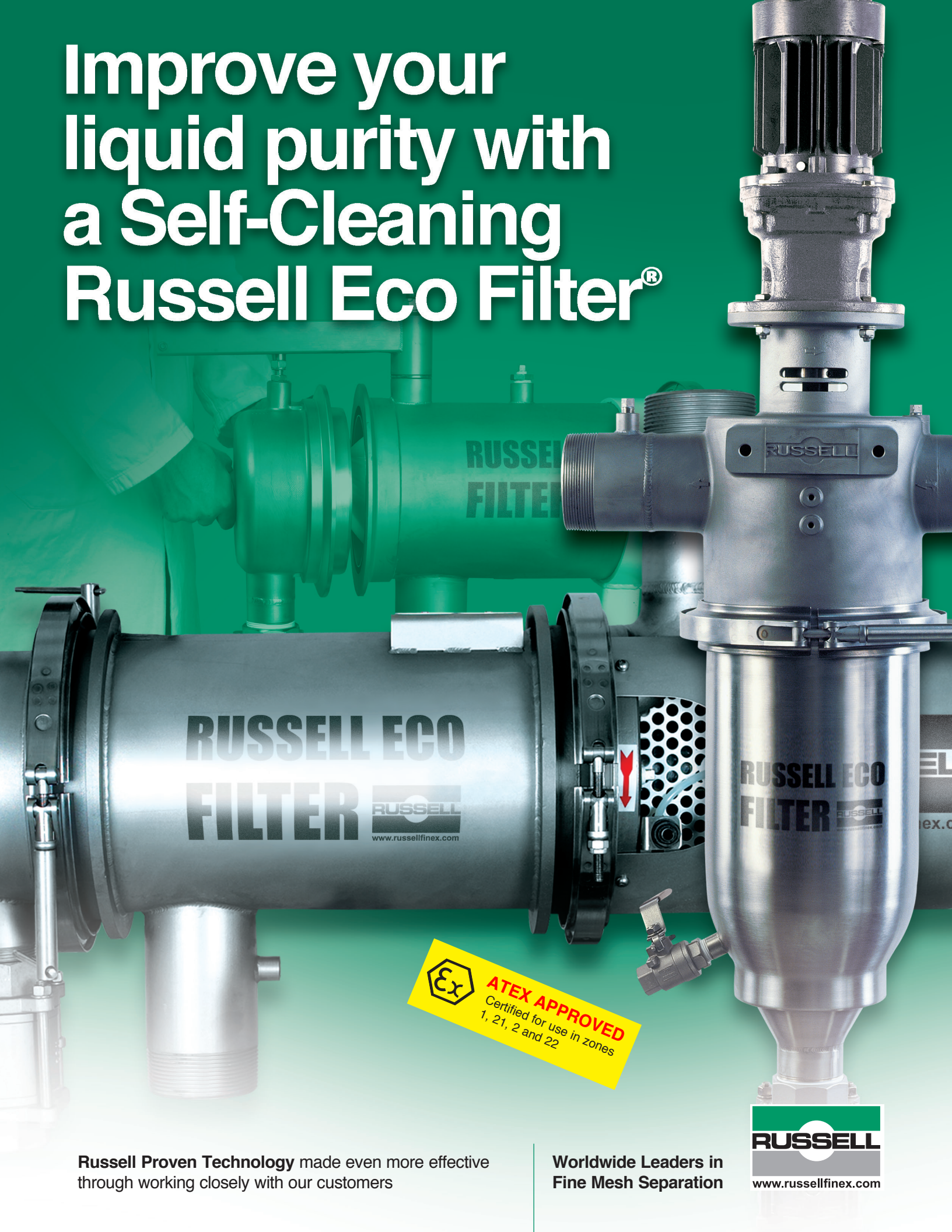

**RUSSELL ECO  
FILTER**



**ATEX APPROVED**  
Certified for use in zones  
1, 21, 2 and 22

**Russell Proven Technology** made even more effective  
through working closely with our customers

**Worldwide Leaders in  
Fine Mesh Separation**



# Ensure your product purity

## Improve your productivity

The **Self-Cleaning Russell Eco Filter®** accurately removes oversize impurities from all types of liquids and pastes. The unique SpiroKlene™ system continuously cleans the surface of the filter element and ensures optimum filtration efficiency. This allows for high and consistent flows, which are ideal for filling operations and continuous production lines.

The Russell filter gives you higher production rates compared to other filtration methods, as there are no production stoppages to change filter bags or cartridges.

The range of filters is designed for ease of operation and maintenance. They are simple to dis-assemble and clean without tools, allowing for fast and efficient product line changeovers, therefore increasing productivity. The units fit neatly into existing production lines, providing considerable filtration capacity without requiring excessive space.



Self-Cleaning Russell Eco Filters® aid quality control procedures for filtering liquid chocolate at Walls Ice Cream.

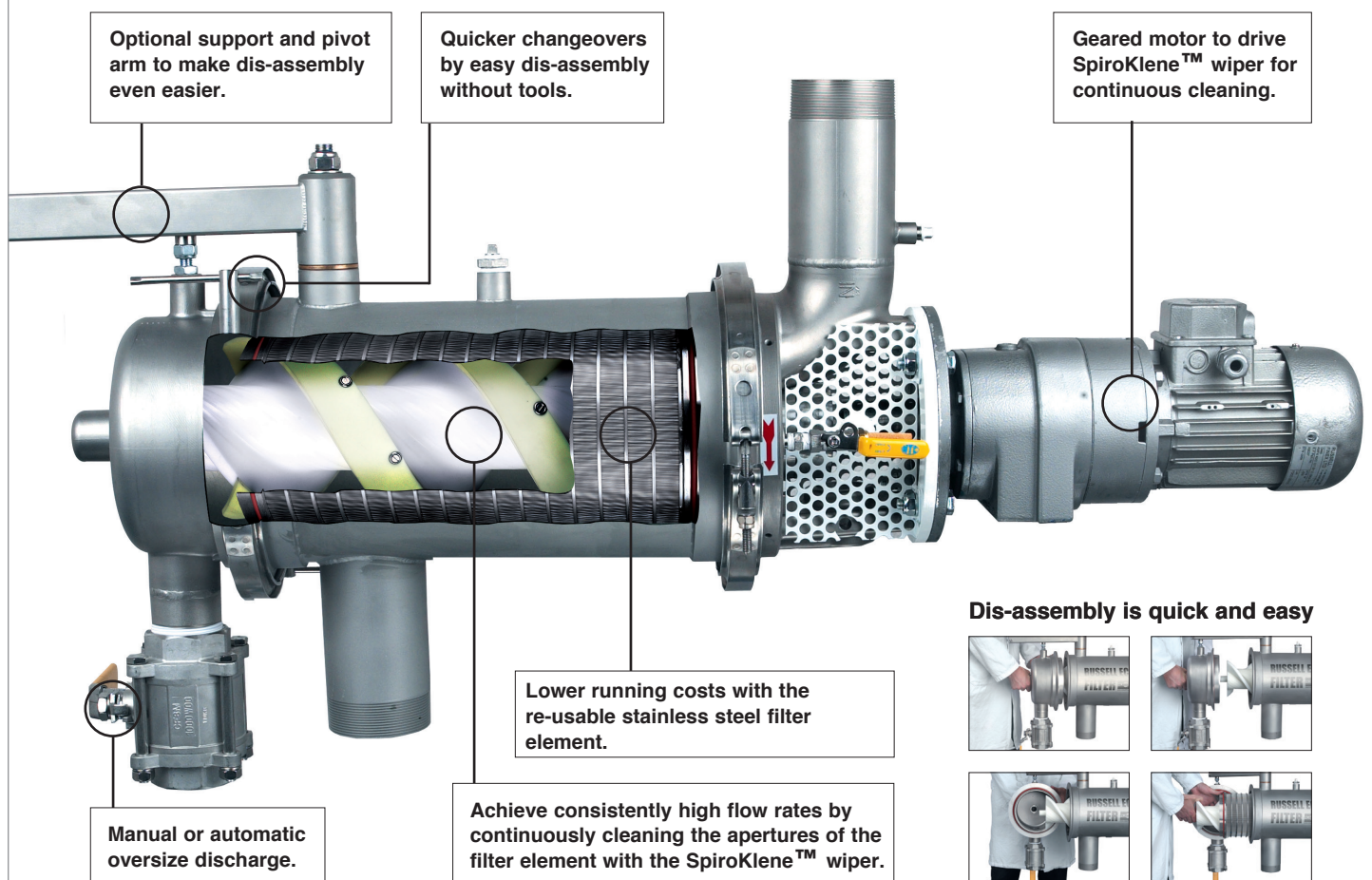

Optional support and pivot arm to make dis-assembly even easier.

Quicker changeovers by easy dis-assembly without tools.

Geared motor to drive SpiroKlene™ wiper for continuous cleaning.

Manual or automatic oversize discharge.

Lower running costs with the re-usable stainless steel filter element.

Achieve consistently high flow rates by continuously cleaning the apertures of the filter element with the SpiroKlene™ wiper.

Dis-assembly is quick and easy

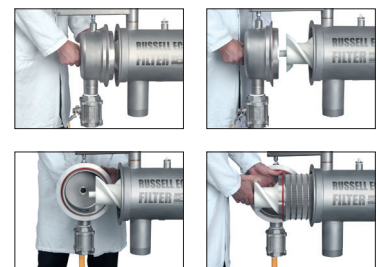

# The Self-Cleaning Russell Eco Filter®

Ensure your reputation  
and win more business

The **Self-Cleaning Russell Eco Filter®** is ideal for high capacity filtration of liquids. It improves the quality of your liquids and ensures your reputation, therefore winning you more business.



## Safeguards your reputation

- The **Self-Cleaning Russell Eco Filter®** ensures the quality of your liquids by eliminating any oversized contamination.
- Total containment of your product prevents any airborne or other contamination from the local environment polluting your product.

## Protects your operators & environment

- Totally enclosed filtration protects your operators from hazardous products, fumes and spillage. It also ensures that your production area stays clean.
- The re-usable filter element removes the need to handle and dispose of messy bags or cartridges.

## Increases your productivity

- Higher capacities are achieved through the continuously cleaned filter element.
- Cleaning between batches is quick and easy without the need for tools. This means minimal disruption during product changeovers and significant savings in labor and downtime.

## Reduces maintenance costs

- The re-usable filter element removes the need to replace and dispose of bags or cartridges. This reduces labor and running costs as well as eliminating landfill charges.

# Safeguard your reputation

## Protect your operators and environment

The totally enclosed Russell filters eliminate the risk of any contamination entering your product and prevent environmental pollution from fumes or spillage.

The re-usable filter element eliminates the costs and environmental implications associated with bags and cartridges - e.g. mess in your production area, ongoing replacement & disposal costs. It also safeguards the health of your operators by reducing their exposure to the product.

We recognize the importance of controlling waste; the savings to be achieved by minimizing product loss during manufacture and the control of what is finally released into the sewage system.

Explosion proof and flameproof units are available including ATEX certification in Europe if required.  
At Russell Finex we are committed to working closely



with customers around the world, supplying solutions to your problems and keeping up to date with changes in legislation that affect your industry.

Over the last 80 years we have solved the filtration problems of almost every type of manufacturing company in the world and often provided customized solutions.

## Some of the industries Russell has helped:

### INKS

Offset  
Cold set  
Heat set  
Gravure  
Flexographic  
Lithographic

### FOOD

Dairy  
Chocolate  
Confectionery

Flavourings  
Breweries/Distilleries  
Beverages  
Oils

### COATINGS

Adhesives  
Plastisol  
Latex  
Wood coatings  
Gel coats  
Resins

### PAINT

Gloss  
Emulsion  
Automotive  
Industrial  
Primer

### CERAMICS

Abrasives  
Glaze  
Clay Slip

### EXTRACTION

China Clay  
Minerals  
Calcium Carbonate

### OTHER LIQUIDS

Waste Oil  
Water Treatment  
Effluent  
Starch  
Tallow  
Metal Slurries

Paper Coatings  
Pharmaceuticals  
Plastic/Rubber  
Cosmetics  
Catalysts  
Detergents  
Chemicals  
Agrochemicals

## Easy installation...whatever your process

### 1 In-line design

This unit is easy to fit into existing pipework without the need for a specialist pipe fitter.

### 2 On-line design

Operates on a unique flow-through principle, which eliminates any dead spots, giving you high volume, continuous production.

### 3 Horizontal On-line design

Strip-down and cleaning time is reduced further. It is even easier to fit into production lines where headroom is limited.

The filters are designed to operate at pressures up to 15 bar (220 psi).  
Higher pressures available upon request

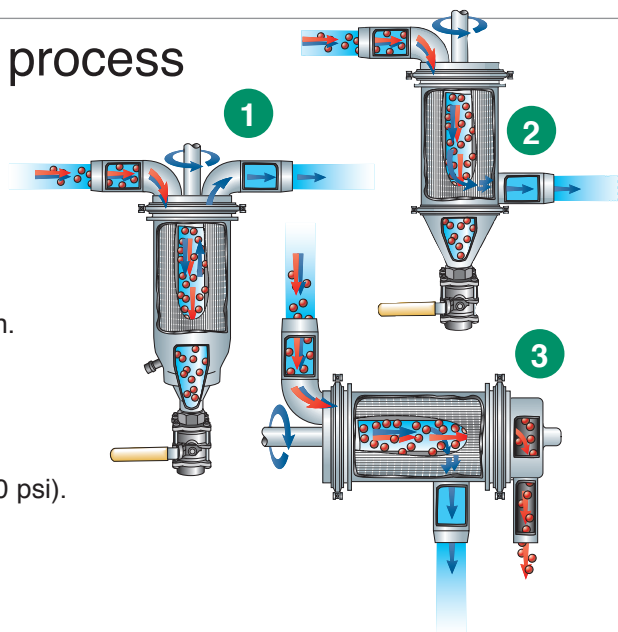

## Improve your process further with the following standard options tailored to meet your needs



Jacketed unit

High temperature unit

### A range of 8 models with a choice of installation to suit your application needs

- **Jacketed unit**  
Heating jacket maintains a high product temperature, e.g. in chocolate processing.
- **High temperature unit**  
Capable of handling liquids such as cooking oils and resins up to 250°C/480°F.
- **Straight wiper systems**  
Ideal for paste type liquids or very difficult to screen liquids.



Straight wiper system

- **Wedge Wire microscreen**  
Increases filtration capacity and offers longer screen life due to the robust design.
- **Defined hole microscreen**  
Provides more accurate filtration than standard screens - the reliable choice when product quality must be beyond criticism.
- **Defined hole supported microscreen**  
Suitable for continuous, high volume filtration where higher running pressures may be required.
- **Hardened microscreen**  
Specially hardened screens provide extended life and wear resistance against abrasive products.

### A choice of filter elements are available to meet the specific demands of your industry

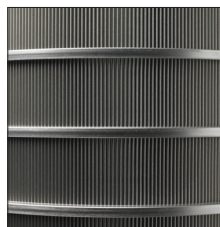

Wedge Wire microscreen



Defined hole microscreen

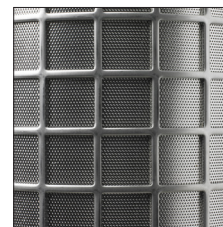

Defined hole supported microscreen

## Remove operator involvement with the Russell Filter Management System™

The system continuously monitors the filtration process enabling the filter to run efficiently without operator involvement. This means reduced labor costs and increased productivity.

- Completely automates your liquid filtration process.
- Improves safety by eliminating operator contact with potentially hazardous products.



- Instantly save money - the system dramatically reduces good product loss.
- Reduce labor costs - no manual supervision is needed.
- Easily retrofits to all types of filter.

# Flow Rate Guide

----- Wedge Wire  
 ——— Unique Russell Microscreen

**Filter Selection Chart (based on  $\Delta P$  of 0.1 Bar using water). For specific applications, further product data would be required. To convert  $m^3/hr$  to gal/min (US), multiply  $m^3/hr$  by 4.4**

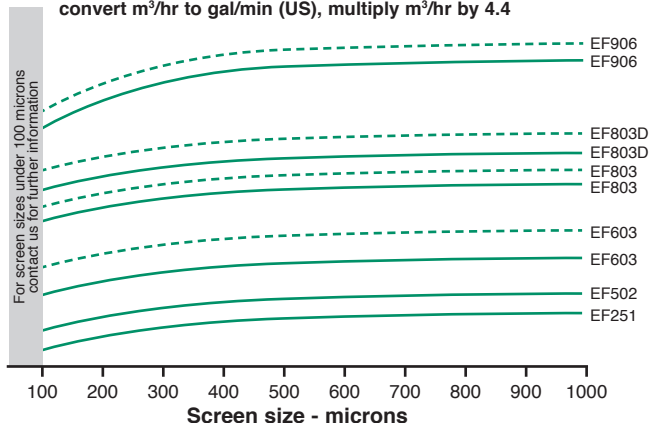

Russell Eco Filter units have streamlined the filtration process at Jotun's plants - specialist coating producers

## Full research and testing facilities



All our filtration equipment is available for extended trials on your premises, while facilities for testing under controlled conditions are provided by state-of-the-art Test and Research Units located at our sites in the UK, Belgium, USA and India. The results of every test are added to a computerized database, which incorporates information gathered by the company since its earliest days. We offer customers confidentiality in regard to specific findings.

## Full technical support and spares service to keep your lines running



We are committed to giving our customers a fast, responsive and reliable support service that helps to keep production lines running. This means full technical support from our technical representatives and the availability of a complete range of spares off-the-shelf. Genuine Russell parts represent excellent value for money and allow units to operate trouble-free at optimum levels of performance. We have our own production facilities for all spare parts which ensures rapid delivery and extremely competitive pricing.

**Call us today to find out how the Self-Cleaning Russell Eco Filter® can improve your product quality and transform productivity. All our experience is at your disposal.**



### Russell Finex Ltd. Feltham, England.

Russell Finex Ltd.  
Feltham, England.  
Russell Finex Limited.  
Russell House, Browells Lane,  
Feltham, Middlesex TW13 7EW,  
England.  
Tel: +44 (0) 20 8818 2000  
Fax: +44 (0) 20 8818 2060  
Email: sales@russellfinex.com



### Russell Finex N.V. Mechelen, Belgium.

Russell Finex N.V.  
Mechelen, Belgium.  
Russell Finex N.V.  
Zandvoortstraat 20  
Industriepark Noord C20  
B-2800 Mechelen, Belgium.  
Tel: +32 (0) 15 27 59 19  
Fax: +32 (0) 15 21 93 35  
Email: sales.nv@russellfinex.com



### Russell Finex Inc. Pineville, N.C. USA.

Russell Finex Inc.  
Pineville, N.C. USA.  
Russell Finex Inc.  
625 Eagleton Downs Drive,  
Pineville,  
North Carolina 28134, U.S.A.  
Tel: +1 704 588 9808  
Fax: +1 704 588 0738  
Email: sales.inc@russellfinex.com



### Russell Finex Pvt Ltd. New Delhi, India.

Russell Finex Pvt Ltd.  
New Delhi, India.  
Russell Finex Pvt Ltd.  
BMS Business Centre, 10, PVR Plaza  
Complex, Connaught Circus  
New Delhi - 110 001, India  
Tel: +91 (0) 11 - 41513601 / 02  
Fax: +91 (0) 11 - 41013603  
Email: sales.rfsf@russellfinex.com

